

- Large Current and Low DCR
- DC/DC-converter
- Current capability up to 2.6A
- Recommended solder profile:Reflow
- ROHS Compliance Product
- Operating Temperature range: -40°C TO +85°C



Electrical Specifications @ 25°C

P/N	OCL@100KHz 0.1V ($\mu\text{H}\pm 20\%$)	D.C.R (m Ω MAX)	RATED CURRENT (A MAX)
PDB5022-1R0M	1	9	8.6
PDB5022-1R5M	1.5	12	7.5
PDB5022-2R2M	2.2	14	7.1
PDB5022-3R3M	3.3	18	6.2
PDB5022-4R7M	4.7	19	5.8
PDB5022-5R6M	5.6	20	5.3
PDB5022-8R2M	8.2	25	4.7
PDB5022-100M	10	31	4.3
PDB5022-150M	15	36	4
PDB5022-220M	22	47	3.5
PDB5022-330M	33	66	3
PDB5022-470M	47	86	2.6
PDB5022-680M	68	130	2.3
PDB5022-101M	100	190	1.8
PDB5022-151M	150	250	1.5
PDB5022-221M	220	380	1.2
PDB5022-331M	330	560	1
PDB5022-471M	470	850	0.82
PDB5022-681M	680	1100	0.72
PDB5022-102M	1000	1800	0.56

Dimensions (unit: inch/mm)

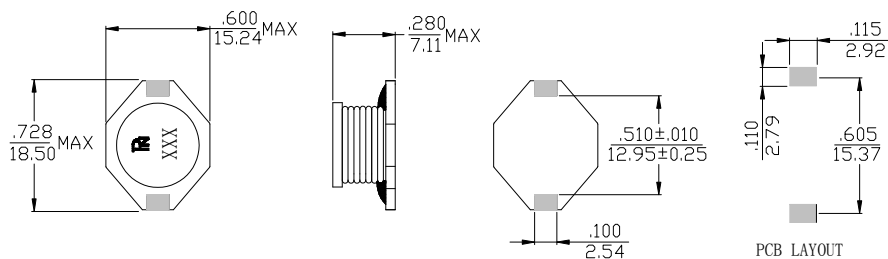

Schematics

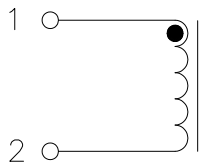

TUSTIN OFFICE:

15991 Red Hill Avenue, Suite #102, Tustin,
California 92780 USA

Tel:+1-714-460-0718 Fax:+1-714-460-0728

<http://www.palnova.com>

SANTA CLARA OFFICE:

3000 Kenneth Street, Santa Clara,
California 95054 USA

Tel:+1-408-855-8866 Fax:+1-408-855-8868