

- Large Current and Low DCR
- DC/DC-converter
- Current capability up to 2.3A
- Recommended solder profile:Reflow
- ROHS Compliance Product
- Operating Temperature range: -40°C TO +100°C



### Electrical Specifications @ 25°C

P/N	OCL@100KHz 0.1V ( $\mu\text{H}\pm 20\%$ )	D.C.R (m $\Omega$ MAX)	RTED CURRENT (A MAX)
PDI75-100M	10	70	2.30
PDI75-120M	12	80	2.00
PDI75-150M	15	90	1.80
PDI75-180M	18	100	1.60
PDI75-220M	22	110	1.50
PDI75-270M	27	120	1.30
PDI75-330M	33	130	1.20
PDI75-390M	39	160	1.10
PDI75-470M	47	180	1.10
PDI75-560M	56	240	0.94
PDI75-680M	68	280	0.85
PDI75-820M	82	370	0.78
PDI75-101M	100	430	0.72
PDI75-121M	120	470	0.66
PDI75-151M	150	640	0.58
PDI75-181M	180	710	0.51
PDI75-221M	220	960	0.49
PDI75-271M	270	1110	0.42
PDI75-331M	330	1260	0.40
PDI75-391M	390	1770	0.36
PDI75-471M	470	1960	0.34

### Dimensions (unit: inch/mm)

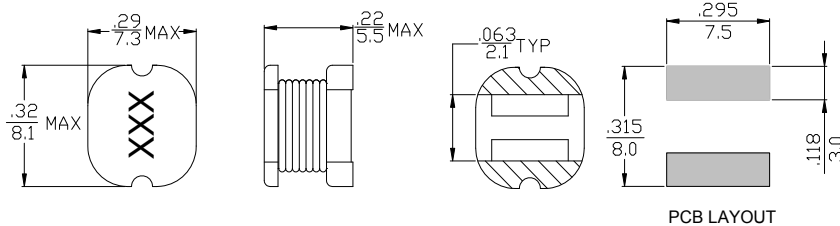

### Schematics

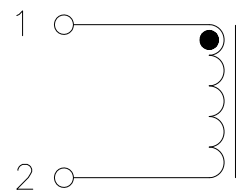

### TUSTIN OFFICE:

15991 Red Hill Avenue, Suite #102, Tustin,  
California 92780 USA

Tel:+1-714-460-0718 Fax:+1-714-460-0728

<http://www.palnova.com>

### SANTA CLARA OFFICE:

3000 Kenneth Street, Santa Clara,  
California 95054 USA

Tel:+1-408-855-8866 Fax:+1-408-855-8868