

- Large Current and Low DCR
- DC/DC-converter
- Current capability up to 8.5A
- Recommended solder profile:Reflow
- ROHS Compliance Product
- Operating Temperature range: -40°C TO +85°C

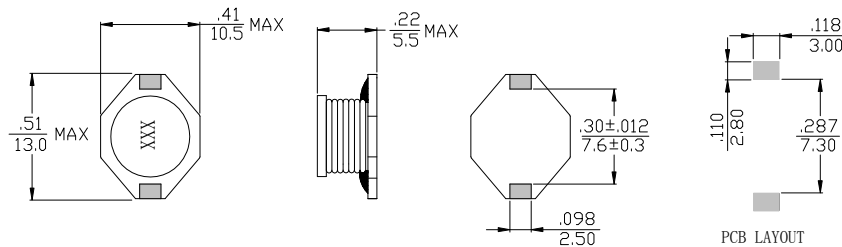

Electrical Specifications @ 25°C

| P/N | OCL@100KHz 0.1V (μH) | D.C.R (Ω MAX) | RATED CURRENT (A MAX) |
|--------------|-------------------------|------------------|--------------------------|
| PDB1005-R68M | 0.68±20% | 0.006 | 8.50 |
| PDB1005-1R0M | 1±20% | 0.007 | 7.50 |
| PDB1005-1R5M | 1.5±20% | 0.009 | 6.50 |
| PDB1005-2R2M | 2.2±20% | 0.012 | 6.10 |
| PDB1005-2R5M | 2.5±20% | 0.012 | 5.50 |
| PDB1005-3R3M | 3.3±20% | 0.015 | 5.00 |
| PDB1005-4R7M | 4.7±20% | 0.019 | 4.50 |
| PDB1005-6R8M | 6.8±20% | 0.03 | 3.40 |
| PDB1005-100M | 10±20% | 0.05 | 2.90 |
| PDB1005-150M | 15±20% | 0.06 | 2.50 |
| PDB1005-220M | 22±20% | 0.1 | 2.00 |
| PDB1005-330K | 33±10% | 0.12 | 1.80 |
| PDB1005-470K | 47±10% | 0.19 | 1.40 |
| PDB1005-680K | 68±10% | 0.24 | 1.20 |
| PDB1005-101K | 100±10% | 0.33 | 1.00 |
| PDB1005-151K | 150±10% | 0.59 | 0.80 |
| PDB1005-221K | 220±10% | 0.78 | 0.70 |
| PDB1005-331K | 330±10% | 1.15 | 0.55 |
| PDB1005-471K | 470±10% | 1.7 | 0.45 |
| PDB1005-681K | 680±10% | 2.6 | 0.35 |
| PDB1005-102K | 1000±10% | 3.9 | 0.30 |
| PDB1005-152K | 1500±10% | 6.3 | 0.25 |
| PDB1005-222K | 2200±10% | 8.2 | 0.20 |
| PDB1005-332K | 3300±10% | 14 | 0.16 |
| PDB1005-472K | 4700±10% | 17 | 0.15 |
| PDB1005-682K | 6800±10% | 30 | 0.11 |
| PDB1005-822K | 8200±10% | 34 | 0.11 |
| PDB1005-103K | 10000±10% | 39 | 0.10 |



Schematics

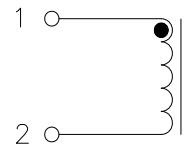

TUSTIN OFFICE:

15991 Red Hill Avenue, Suite #102, Tustin,
California 92780 USA

Tel:+1-714-460-0718 Fax:+1-714-460-0728

<http://www.palnova.com>

SANTA CLARA OFFICE:

3000 Kenneth Street, Santa Clara,
California 95054 USA

Tel:+1-408-855-8866 Fax:+1-408-855-8868